

Issue 05  
March 2013

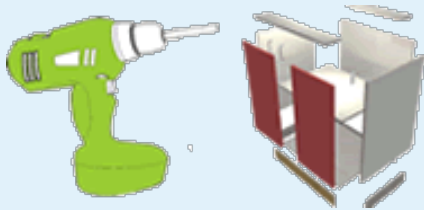

### Need some help?

1

Read these instructions before you start any assembly

2

Read any instructions that were included in your accessories and hardware elements

3

Check out our website for other product downloads



If you still can't get it to work, then call us on 0438 215 652.

## It's all about timing...

Thanks for purchasing our flatpack cabinets for your next project.

Our aim is to make it quick and simple to create your ideal kitchen, thanks to our unique mortice-and-tenon assembly method.

Like anything, if you take a few moments to read and understand this booklet, you'll be up and running in no time – no seriously, we recommend it!

As an estimate, allow about half an hour to assemble your first cabinet, and then about 20 minutes there after once you have the system worked-out.

Drawer units and specialty cabinets can be a little bit trickier, so don't stress out if they take a bit longer.

## typical components

## Before you begin, make sure you are ready

Check your order – make sure you have all of the cabinets and components you ordered before you begin any assembly.

Typically, your order will contain:

- Assembly & installation instructions – read these thoroughly before you begin anything
- Cabinet carcasses – each cabinet may consist of several shrink-wrapped bundles. These will be labeled with the relevant cabinet number
- Doors, panels & kickboards\*
- Assembly hardware\*
- Drawer kits\*
- Benchtops\*
- Bulkheads\*

\*design specific, where ordered

We do not include:

- Installation hardware – this will depend on the type of walls you are fixing to
- Silicon (neutral cure), for benchtop joints

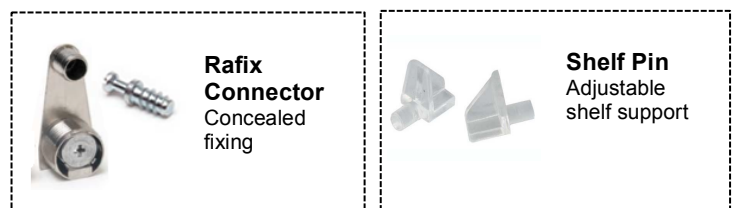
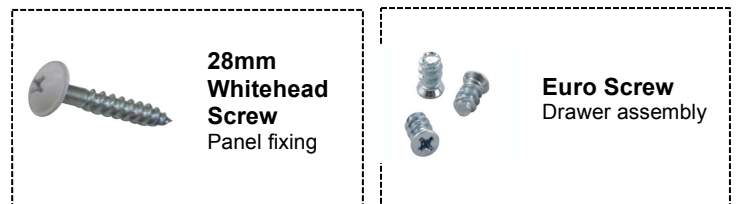
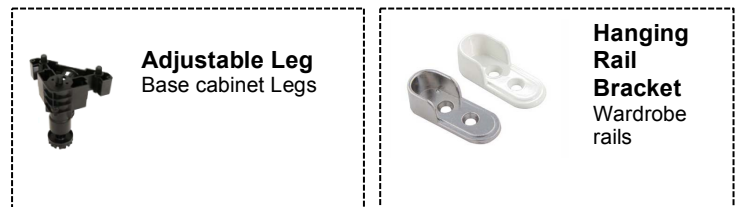
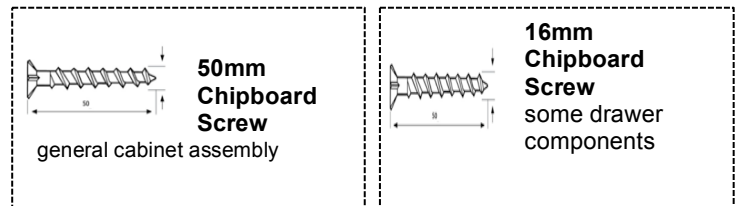

Some components are design specific, and may not be listed here.

## Door Hinges – specific functions

Depending on your design, there may be an assortment of door hinges for various functions. If the wrong hinge is used in the wrong application, it will not work.

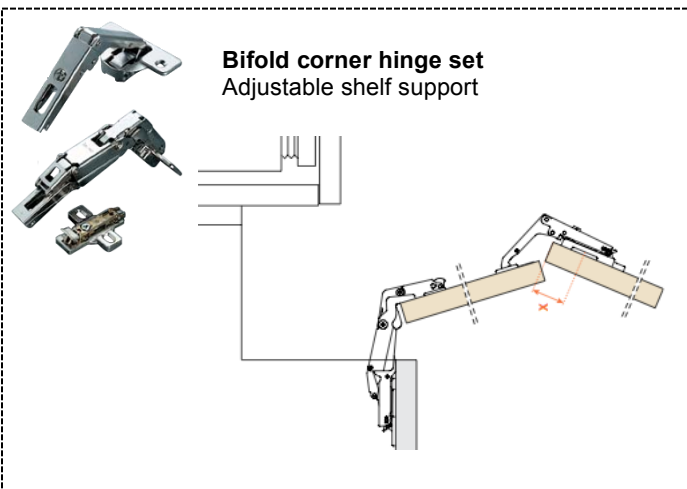
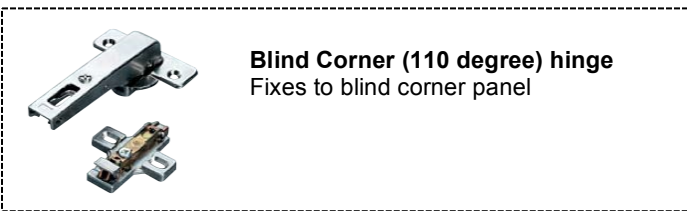

Other hinge types include angled and glass doors. These will vary based on the cabinet design.

Once the cabinets and benchtops are fully installed, go through and adjust all of your hinges to align the doors accordingly.

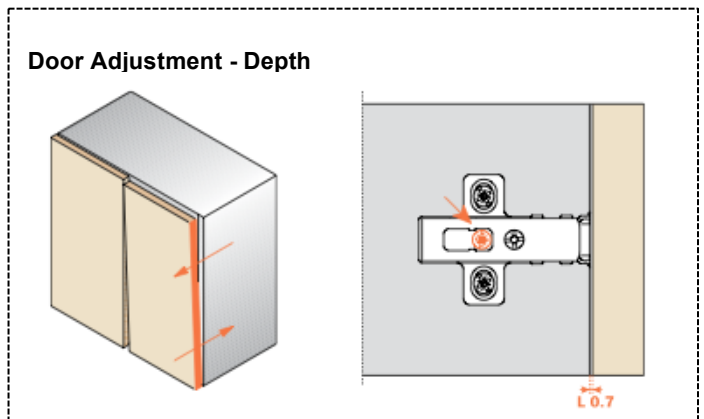
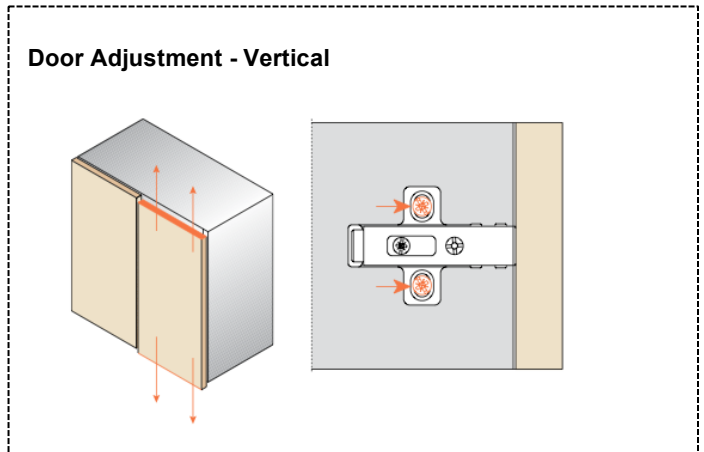
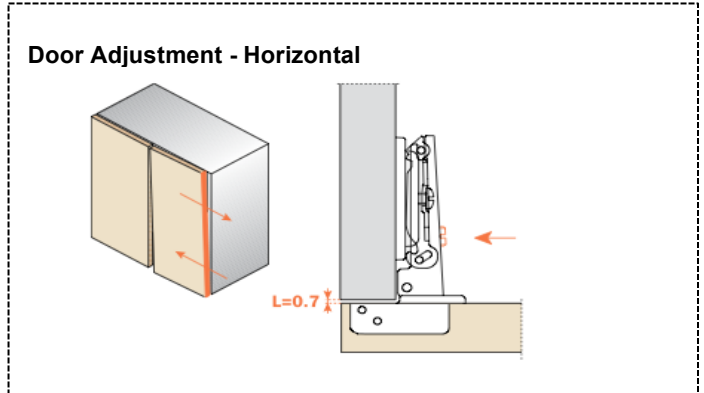

Some basic

# Principles

To save yourself the time and frustration in making things back to front, here are our basic assembly principles to help get you going.

Do NOT glue the components – if you have made a mistake, you cannot un-gluce.

Some parts are interchangeable at first, but will conflict when fully assembled. This is so with fixed shelves (see below) where the tenon must be centred to the assembly screw hole.

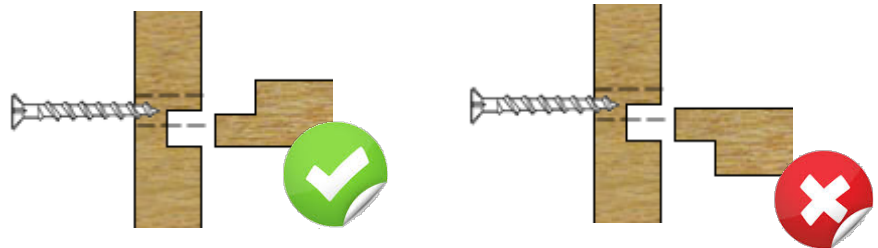

## Do you LEGO?

If you failed with LEGO as a child, then perhaps flatpack isn't the best solution.

However, if you persevere and take the time, you will save yourself \$\$\$ by assembling and installing these cabinets yourself.

When carcasses are fully assembled, all of the parts will be flush fitting. The sides, back, top (stretcher) and decks will all be aligned to the external faces. The exception to this rule is the base corner cabinet – the backs will be inset 16mm for wall clearance.

Where parts are visible in the final assembly position, they will have edge-banding. Ensure that all parts facing outwards are edged (ie no raw edges)

# Cabinet Assembly

## Base Cabinets



Save time...

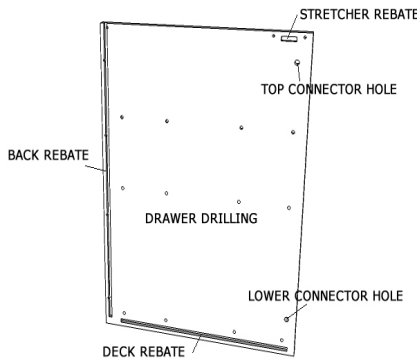

Typically, all of our cabinets are assembled in the same manner, however there are a few differences between the types.

Base cabinets consist of either hinged or drawer configurations, so the internal drilling patterns will change.

Attach the *hinge blocks* and *drawer runners* to the cabinet ends when they are flat – this is handy if you have a narrow cabinet that you can't get into with a cordless driver once you have assembled it.

On *corner cabinets*, place the adjustable shelf inside as you built the cabinet. This will make it easier than trying to force the shelf through the door opening once it is assembled. Really useful where corner cabinets are asymmetrical.

1

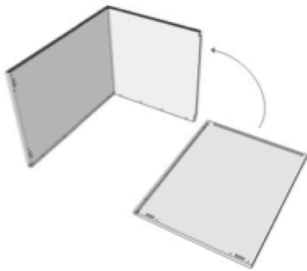

Start with the deck (bottom). Place it finished edge up on a solid surface. Fold the left hand end up, ensuring the finished edges are flush to the deck. Screw together with 50mm chipboard screws. (If concealed fixings are applied, use the Rafx connectors).

If the cabinet has fixed shelves, then position these before you put the right hand end on.

Do the same for the right hand end.

2

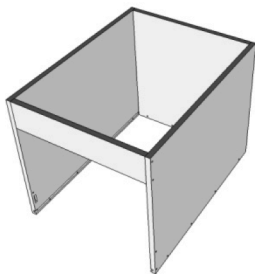

Screw in the front stretcher or top using 50mm chipboard screws. On a sink cabinet, the front stretcher will be rotated vertically to accommodate the sink cutout.

(Base Cabinets continued)

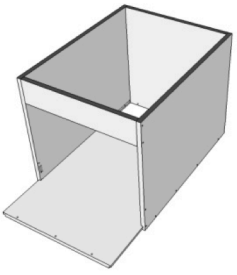
<p>3</p> 	<p>Slide the back panel into the rebate – the back and the sides will be flush at the rear of the cabinet ( no gap at the back). The only exception to this are corner base cabinets, where there is a 16mm rebate on the two backs for wall clearance.</p> <p>Screw the back in from the sides, as well as the deck, using 50mm chipboard screws.</p>
<p>4</p>	<p>Screw in the hinge blocks and the drawer runners.</p> <p>If a drawer runner blocks the connector hole position, the drawer runner will take priority. This may occur on the lowest drawer in a drawer bank.</p>
<p>5</p>	<p>Knock the adjustable legs into the deck (bottom) of the cabinet. Make sure they are the same distance from the front of the edge, as this will affect the kickboard position.</p>

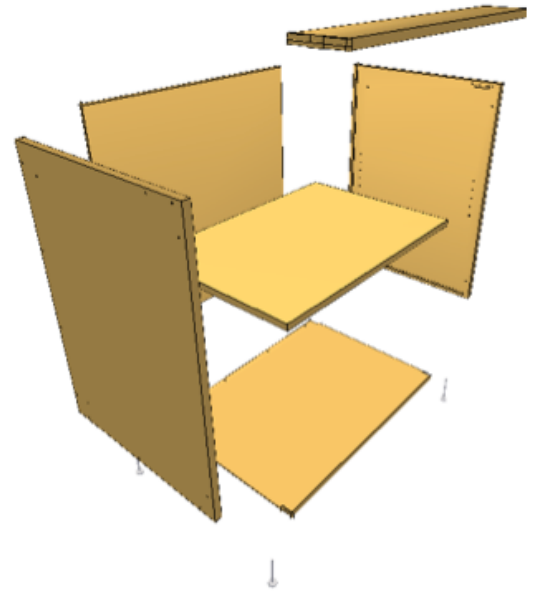

## Cabinet Assembly

# Standard Drawers

Depending on the design & upgrade options available, there are various drawer systems on offer.

This is our standard drawer unit, and consists primarily of:

- 2x metal drawer sides
- 2x metal drawer guides
- 2x front drawer brackets
- 1x melamine drawer base
- 1x melamine drawer back
- gallery rails (pot drawers)
- gallery rail brackets (pot drawers)

Using Euro screws, screw the drawer guide as close to the finished front edge of the carcass as possible, without protruding past it.

Attach the melamine drawer base to the drawer side using Euro screws. The drawer base will sit inside the metal side.

Place the melamine drawer back with the finished edge at the top. The pre-drilled holes face the back of the cabinet, and these are attached to the metal drawer side with Euro screws. Screw the melamine drawer base to the melamine drawer back using 50mm chipboard screws.

Attach the drawer brackets to the drawer front. The holes will be pin-drilled for placement. Use the 16mm chipboard screws. Depending on the drawer brand, these brackets will be left- & right-handed.

Attach the drawer front (with attached brackets) to the metal drawer sides and tighten up.

**POT DRAWERS** will have gallery rails. Attach the gallery rail bracket to the back of the melamine drawer back using Euro screws. Place the gallery rail dowel end into the pre-drilled holes on the back of the drawer front, and then clip it into the gallery rail bracket. You can adjust the drawer front tilt by twisting the gallery rail.

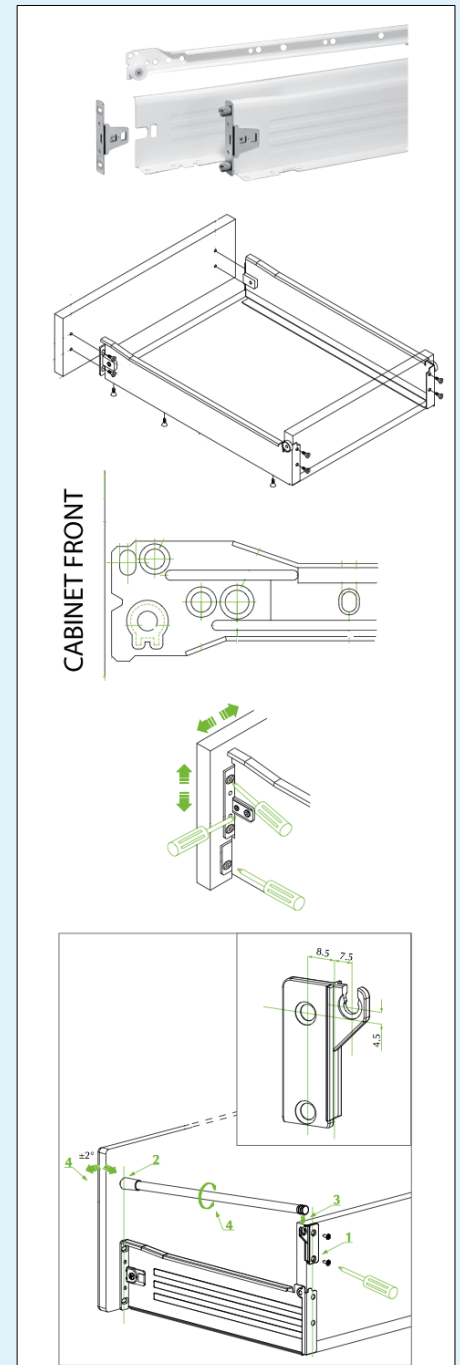

# Cabinet Assembly

## Soft Close Drawers

### Soft Close Drawer System – Grass DWD-XP

This is our standard soft-close drawer upgrade kit, and is boxed complete with all components:

- 2x metal drawer sides
- 2x metal drawer runners
- 2x front drawer brackets
- 1x melamine drawer base
- 1x melamine drawer back
- gallery rails & brackets (pot drawers)
- assembly instructions are include in each boxed kit, but we have simplified them below.

Using Euro screws, screw the drawer guide as close to the finished front edge of the carcass as possible, without protruding past it.

Using Euro screws in the pre-drilled locations, fix the melamine drawer base to the metal drawer sides.

The melamine drawer back is attached using 50mm chipboard screws from the underside of the melamine drawer base. The metal back brackets will hold the drawer back in place, and lock it to the metal drawer sides.

Attach the drawer front brackets using 16mm chipboard screws to the back of the drawer front.

POT DRAWERS will have a taller metal back bracket that accommodates the gallery rail bracket. On drawers narrower than 400mm depth, the gallery rail bracket is screwed on separately (as per standard metal drawer system).

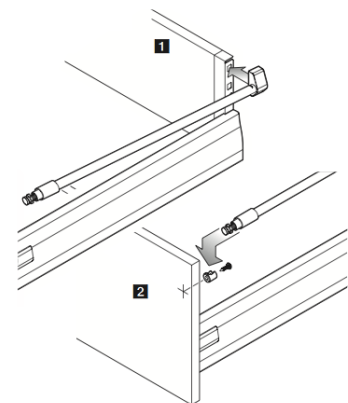
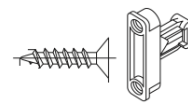
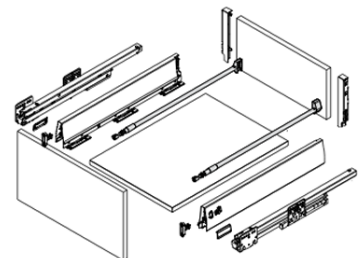
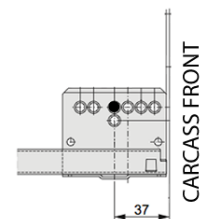
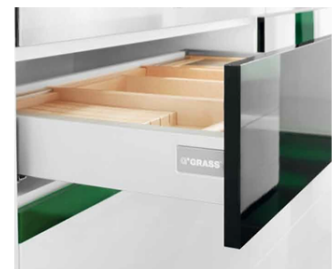

## Cabinet Assembly

# Inner Drawers

Inner drawers are the same as external drawers, with some exceptions:

- Some configurations may have a standard melamine drawer front to attach a handle;
- Some configurations may have a pre-formed drawer front, that is cut to size. Sometimes these will have a handle or gallery rail incorporated as part of the drawer front, and the front brackets will be different to the drawer kit front brackets.

Inner drawers may require a drawer guide spacer to be attached between the drawer guide and the cabinet carcass. Spacers will come in two different designs, depending on the drawer system select



Grass DWD-XP  
Drawer Spacer



Uniset Drawer  
Spacer

## Cabinet Assembly

# Wall & Tall Cabinets

Wall cabinets are assembled the same as base cabinets, with the following exceptions:

- The left & right ends are edged on the bottom of the cabinet
- Instead of a top stretcher, the cabinet will have a full top. The full top is screwed from the back using 50mm chipboard screws.

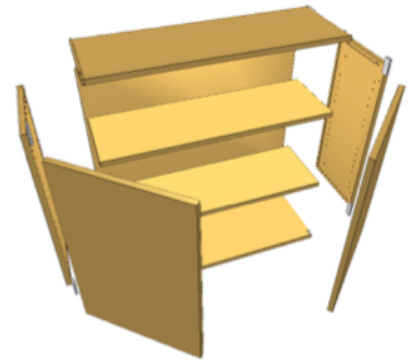

## Cabinet Assembly

# Corner Cabinets

Corner cabinets are assembled the same way as base cabinets, with the following exceptions:

- There is a 16mm void on the two backs of base corner cabinets. This allows for the build-up of plasterwork against the wall corner. The deck will run the full depth of the cabinet for stability, but if it interferes with the wall, it can be trimmed back as needed for clearance.

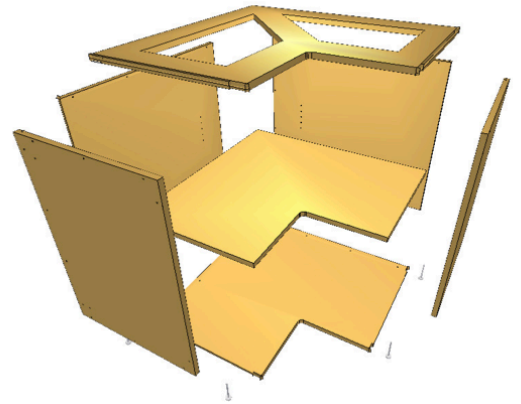

## Cabinet Assembly

# Oven Cabinets

Corner cabinets are assembled the same way as base cabinets, with the following exceptions:

- There is a fixed shelf with a ventilation hole for beneath the oven
- The top stretcher is rotated, same as a sink cabinet
- The door panels are glued in place to the stretcher and bottom /fixed shelf.
- You may need to pack your oven up using timber strips for the correct door clearance. Refer to the manufacturer's instruction.

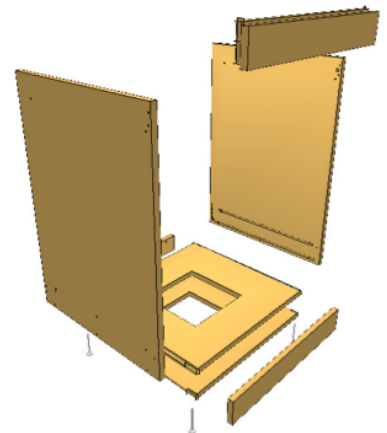

## Cabinet Assembly

# Blind Corners

Blind Corner cabinets are assembled the same way as base cabinets, with the following exceptions:

- The cabinet consists of a fixed panel and a door. The fixed panel can be attached the stretcher & deck by either:
  - screwing from the face of the panel into the stretcher & deck with a 50mm chipboard screw. Take care to ensure that the screws will be concealed by the adjacent cabinet; or
  - attaching 25x25 metal angle brackets to the inside of the fixed panel
- The door hinges will typically mount to the fixed panel. In some instances of storage accessories, the door may mount to the accessory mechanism. Refer to the assembly instructions for your selected accessory.

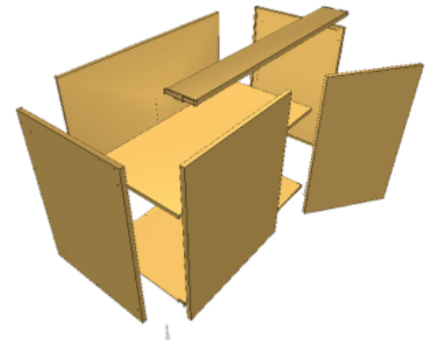

## Cabinet Assembly

# Open Cabinets

Open cabinets can be shelf units, microwave boxes or specialty cabinets.

Depending on the layout, open cabinets are assembled using 50mm chipboard screws, Rafx connectors, or a combination of both. The method is determined by the placement in the overall layout, and if there are any exposed ends.

Rafx connectors are used for a concealed fixing method. Knock the cammed Rafx component into the  $\frac{3}{4}$  hole cutout in the melamine component. Tap it in gently, making sure the tab is aligned with the 10mm hole for strength. Be careful, as the cammed rafx is designed NOT to come out easily if you don't knock it in squarely.

Screw the Rafx pin to the corresponding 5mm hole on the adjacent melamine component. Push the pin into the cammed end and tighten gently but firmly using a Phillips screwdriver. Do not over-tighten.

Where components are screwed together, we recommend pre-drilling components to prevent "blow out" in the MDF substrate.

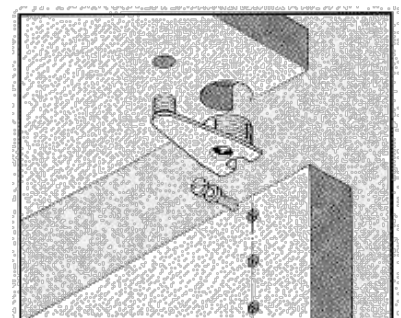
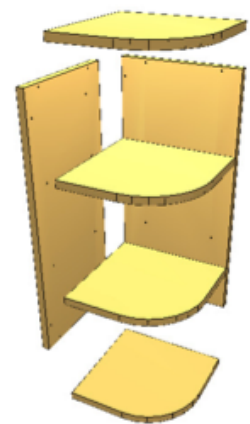

## Cabinet Assembly

# Fillers & Panels

Fillers are used to infill the gaps between cabinets and walls, where a greater clearance is required than that offered by an Applied Panel. They are also used to provide drawer clearances for corner layouts.

- They are supplied oversize to allow for scribing (trimming) to the wall or cavity. They can be cut using a jigsaw, circular saw, hand saw or electric plane.
- The face panel is silicon or glue fixed to the blok from behind. The block is then screw fixed to the adjacent cabinet.



Panels are used to terminate a cabinet as a dress piece, or where a tall and base cabinet meet to conceal assembly & fixing holes.

- They are screw fixed from the inside of the adjacent cabinet for a concealed fitting. Use 28mm whitehead screws.

Applied Panels are just small width Panels that are used instead of a Filler. These are generally used against walls for a tailored finish.

## Cabinet Assembly

# Bulkheads

Bulkheads are the infill elements that site between tall / wall cabinets and the ceiling. They are made from raw MDF craftwood to prevent cracking from cornice cement.

- Assemble using Rafx connectors for a concealed finish
- Bulkheads sit on top of the tall / wall cabinet, and are screw fixed through the interior top of the cabinet

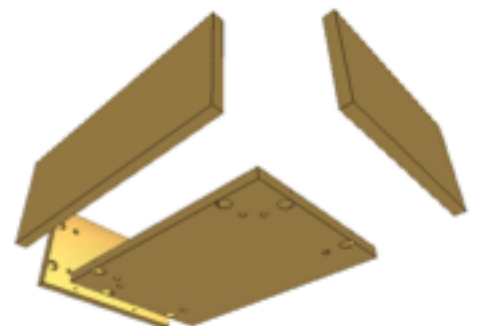

# Cabinet Installation

## Typical Guide

**These installation instructions are intended as a generic guide only. Each design may require a different approach.**

### Base Cabinets

1. As a general rule, we usually begin installing with any base corner cabinets, and then work around the base cabinets from there. Next, place any tall cabinets, and go onto the wall cabinets. This might alter based on your actual design.
2. Stand your corner cabinet into place, or an end cabinet, depending on your cabinet layout.
3. Using a spirit level placed on top of the cabinet, level the cabinet by winding the adjustable feet in and out.
4. Place the next cabinet up against the first. With the spirit level, adjust the cabinet until it matches the first cabinet. Make sure the top and front of the carcasses align with each other.
5. Join the two cabinets together using a cabinet connector fitting. If a pre-drilled connector hole is blocked by a drawer runner, then join the cabinets using a 28mm whitehead screw instead.
6. Don't forget to place and panels and fillers as required by your design.
7. Fix your cabinets to the wall 75mm wood screws at the studs. If there are gaps between the cabinets and the wall, pack this out to prevent the cabinet from twisting as you screw it into place. Do not over tighten, to allow for movement.

### End panels

1. Your end panels are manufactured to the overall cabinet height as per your design. You will need to determine the lowest point of your room, and work back from that to ensure that all end panels will meet the floor.
2. Cut any excess length from the bottom of the panel, so it matches the floor contour.
3. Attach the end panel from the inside of the carcass using 28mm whitehead screws.

### Kicks

1. Attach the adjustable feet to the underside of base cabinets. These are used to level your cabinets for uneven floors.
2. Your kick board will typically be higher and longer than you require. This is to allow for scribing the board to follow the floor. Use a jigsaw to shape the kickboard for a neat flush finish.
3. Using silicon, attach your toe kick to the adjustable feet.

# Cabinet Installation

## Typical

### Wall cabinets

1. Measure from the top of your tall cabinets the distance of the height of your wall cabinets.
2. Mark a level line on the wall – this is the baseline of your wall cabinets.
3. If you do not have any tall cabinets then the distance between the benchtop height and base of wall cabinet should be a minimum of **600mm for electric cooktops, and 650mm for gas** cooktops to comply with Australian Codes.
4. Find the wall studs.
5. Place wall cabinet into position and screw into the wall studs with 75mm wood screws. If you cannot locate any wall studs, you will need to provide some Wallmates or alternate fixing method. For masonry walls, you will need to use expanding plugs for the screws to grip.
6. For fridge cabinets, these are typically installed flush to the front of any adjacent cabinet or end panel. Fridge cabinets are not fixed to the wall to allow for a ventilation void to prevent the fridge from overheating. In some layouts, this will also include cabinets above microwaves and/or ovens.

### Bulkheads

1. Cut bulkhead to suit the gap above your cabinets.
2. Screw into place from inside the cabinet through the top panel using 28mm whitehead screws.

### Ovens

Oven cabinets are made to suit the actual opening size provided by your manufacturer. In some instances, you will need to pack the oven underneath with scrap timber to ensure that the door fits into the allowed opening size. Refer to the manufacturer's recommendation for this clearance.

Some materials may require you to fit a heat shield. This will be determined by the manufacturer's recommendation, and will depend on the heat levels and door design of your oven.

### Doors & Drawer Fronts

1. Don't bother attaching your doors or drawer fronts until you have all of the carcasses fixed into place. They will just get damaged.
2. Fit the hinges to the doors, and then clip them onto the hinge mounting block that is screwed to the carcass.
3. Fit drawer fronts according to the drawer type.
4. Adjust doors & drawer fronts accordingly & attach your handles.

# Cabinet Installation

## Benchtops

Laminate, timber and acrylic benchtops will be made to suit the layout of your design. These will typically be supplied with your flatpack cabinet order.

Stone benchtops will be fitted by a stone mason once the cabinets have been installed.

### Laminate & Timber Benchtopy Installation

1. Typically speaking, the front of the benchtopy will sit 40mm proud of the base cabinet carcass (or 20mm proud of the cabinet if you have installed the doors)
2. Our corner benchtops are cut with a Masons' Mitre join for a professional finish.
3. Place the benchtops into position as a dry run to ensure they fit. You may need to trim against any walls that are not flush.
4. Place benchtops into position, place Clear Silicon into the joint and tighten joint with bench connection bolts.
5. As you tighten, ensure the top of the benchtops are level with each other for a clean, flush finish.
6. Screw the benchtopy from beneath through the front stretchers using short whitehead screws.

### Acrylic Benchtopy Installation

Follow the steps as for Laminate & Timber, but instead of silicon joints, you will need to glue and polish the joints on-site.

### Stone Benchtopy Installation

Stone should not be attempted if you have not done it before, and/or you do not have the correct equipment for cutting, polishing & handling of the material.

Our stone benchtops are only offered as a fully installed product through our qualified and experienced stone masons. Once your cabinets have been installed, contact us to arrange for a site measure by our stone mason. They will also template the sink & cooktop to suit the layout.

In some simple instances (eg single pieces or vanity tops), the stone may be offered pre-cut and pre-finished. In this instance, the stone is silicon fixed to the cabinets.

# Thank You

We strive to create a product that meets the needs of our customers.

To help us in the future, we welcome you to send us your feedback – good, bad or indifferent, it all helps us to improve.

Please go to <http://www.surveymonkey.com/s/M2RPW85> to complete our short questionnaire.

You can also claim a free gift on completion.



Custom Flatpack Pty Ltd

Issue 05: March 2013

Custom Flatpack Pty Ltd

11 Shropshire St, Queanbeyan, NSW, 2620

PO Box 15, Calwell, ACT, 2905

ABN 31 139 481 575

[www.customflatpack.com.au](http://www.customflatpack.com.au)

[support@customflatpack.com.au](mailto:support@customflatpack.com.au)

All of our components are designed and manufactured in Australia using board products manufactured to Australian Standards, and from sustainably managed timber sources.

All of the hardware we use are of the highest proven quality from around the world.

